

ITEM NO.	SIZE AND DESCRIPTION
1	(8"x8"x16") CONCRETE OR SLUMP BLOCK (SOLID GROUT ALL CELLS)
2	COLD JOINT STRIP
3	(7'-4" X 5'-4" X 4" THICK) CONCRETE PAD
4	FIRE HYDRANT - SEE NOTE 1.
5	(8"x8"x16") CAP BLOCK.
6	#4 REBAR, TYPICAL - SEE NOTE 2. REBAR SHALL CONFORM TO ASTM A615, GRADE 60
7	CONCRETE FOOTING, CLASS 560-C-3250 PER SSPWC SECTION 201

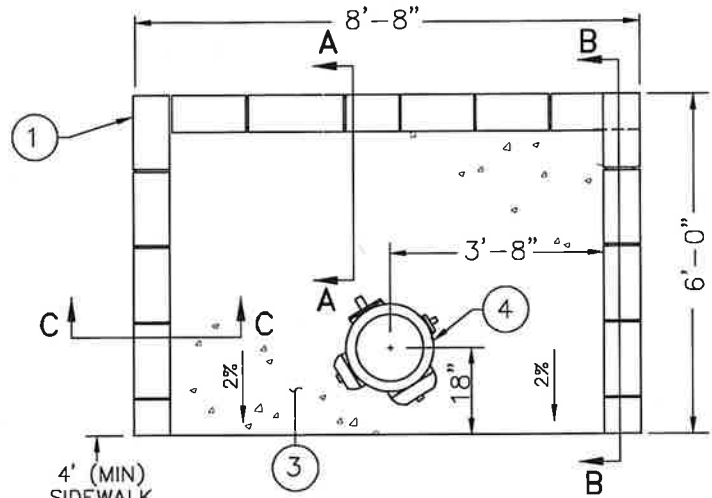

PLAN VIEW

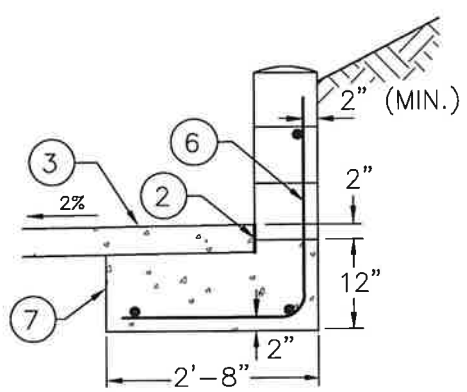

SECTION A-A

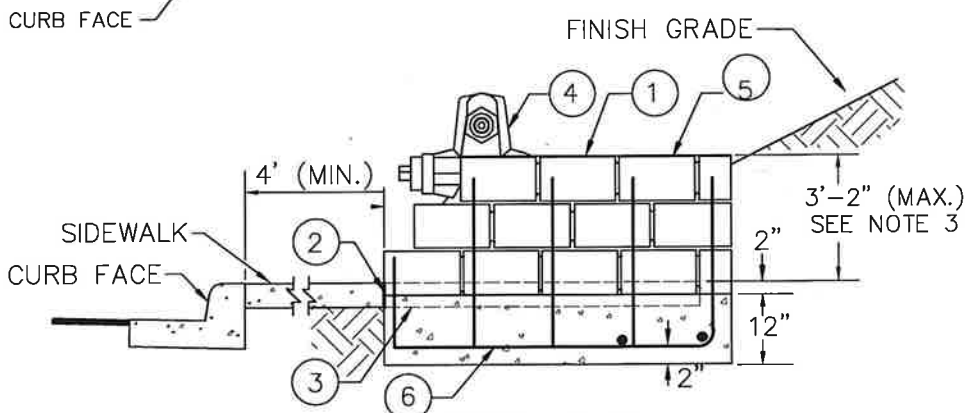

SECTION B-B

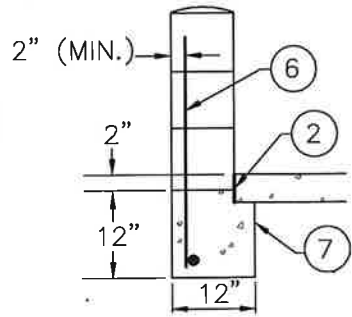

SECTION C-C

- NOTES:
- 1 RETAINING WALLS SHALL BE INSTALLED WHERE SHOWN ON THE PLANS OR AS DIRECTED BY THE ENGINEER.
  - 2 VERTICAL BARS TO BE INSTALLED AT 16 INCH ON CENTER
  - 3 RETAINING WALLS IN EXCESS OF 3'-2" SHALL BE DESIGNED BY THE ENGINEER OF WORK
  - 4 SUBMIT BLOCK STYLE AND COLOR FOR PRE-APPROVAL BY THE UTILITY.
  - 5 A 36" CLEARANCE SHALL BE MAINTAINED OF ANY OBSTRUCTION FROM FIRE HYDRANT TO THE WALL
  - 6 OMIT MORTAR FROM VERTICAL JOINT OF FIRST BLOCK COURSE ABOVE FINISHED GRADE TO PROVIDE WEEP HOLES FOR SUB-DRAINAGE PURPOSES

RETAINING WALL FOR FIRE HYDRANT AND OTHER WATER APPURTENANCES

CITY OF MONTEREY PARK  
PUBLIC WORKS DEPARTMENT WATER DIVISION

STANDARD NO.

**W-608**

DRAWN	BY	DATE
	AM	10/02/24
REVISED	DZ	10/02/24
CHANGED	XX	10/02/24

APPROVED WATER UTILITY MANAGER	<i>[Signature]</i>	DATE	12/10/24
APPROVED CITY ENGINEER	<i>[Signature]</i>	DATE	12/11/24

SHEET 1 OF 1